

## Advanced Engineering Capabilities

- Choice of Cast-in-place & Prestress Precast column
- Develops interaction curves
- Customized reinforcement / Strand placement
- Optional closed Tie Bars
- Customized allowable stresses in concrete
- Provision for type of pre-stressing tendons
- Units in FPS System

## Reinforcement Options

- Reinforced concrete column
- Prestressed concrete column

## Loading Options

- Axial loads
- Bending moments

## Type of Columns

- Rectangular column
- Slender column

## Design Codes

- ACI 318-08
- PCI Design Handbook 7th Edition

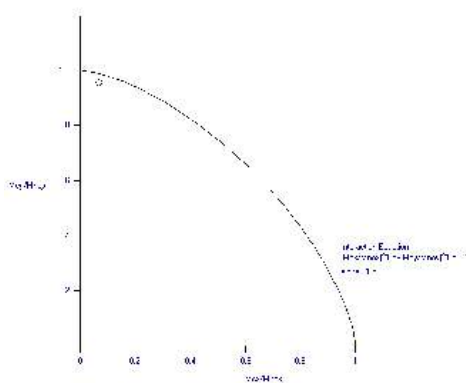
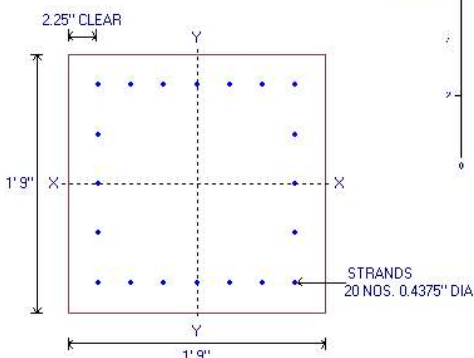

# PCPack Column 2010-5

Efficiently Optimized Design for Reinforced  
Prestressed / Precast Concrete Column

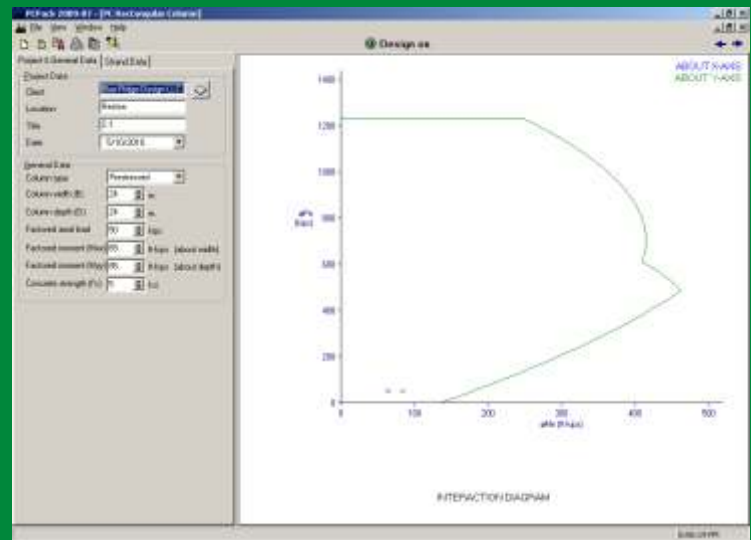
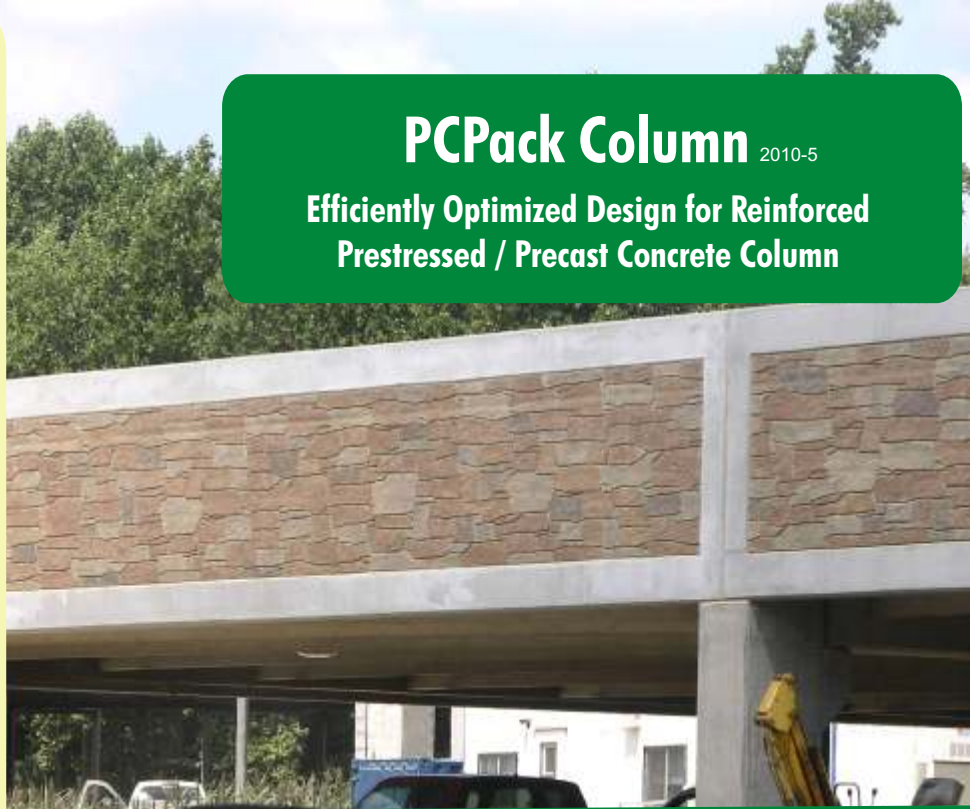

## User Friendly Features

- On-screen user manual and context sensitive help
- User friendly graphical interface
- User defined graphical cross section editor
- Alert for incorrect inputs
- Saves the latest design inputs as default
- Comprehensive summary reports
- Analysis result plot diagrams in terms of graphical output
- Export data to spreadsheet or MSWord